



Carlton Hill | NW8



We are delighted to offer a well-proportioned (398 sq ft) studio apartment in the ever popular Carlton Hill Estate. Carlton Hill is located close to Hamilton Terrace and therefore benefits from being close to either Maida Vale (Bakerloo Line) underground station or St John' s Wood (Jubilee Line). St Johns Wood and Little Venice offer a good selection of boutique shops, restaurants and cafe's with the numerous bus links on Maida Vale (A5) providing links into London's West End and Marble Arch.

The apartment is arranged on the 1st floor and consists of a sperate kitchen, 3 piece bathroom and a bright studio room fitted with a pull-down bed.

Westminster Council
EPC - E

Leasehold
125 yrs from 1982, (approx 90 years remain)
SC £ 652 per annum

Asking Price £370,000

Lettings: 020 7625 1000
Sales: 020 7625 7000



www.greenstone.com



www.facebook.com/greenstoneproperty



www.twitter.com/lewisgreenstone



www.youtube.com/user/greenstone



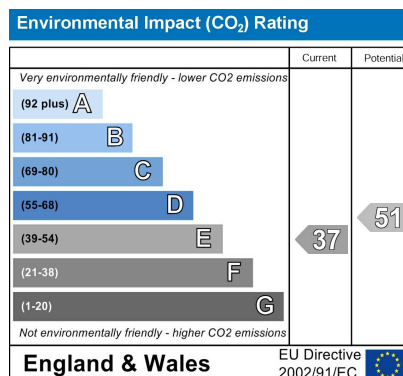
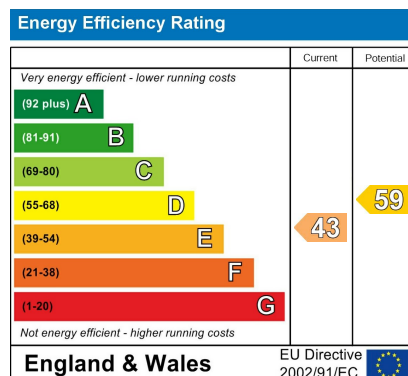

Lettings: 020 7625 1000
Sales: 020 7625 7000



www.greenstone.com



www.facebook.com/greenstoneproperty



www.twitter.com/lewisgreenstone



www.youtube.com/user/greenstone



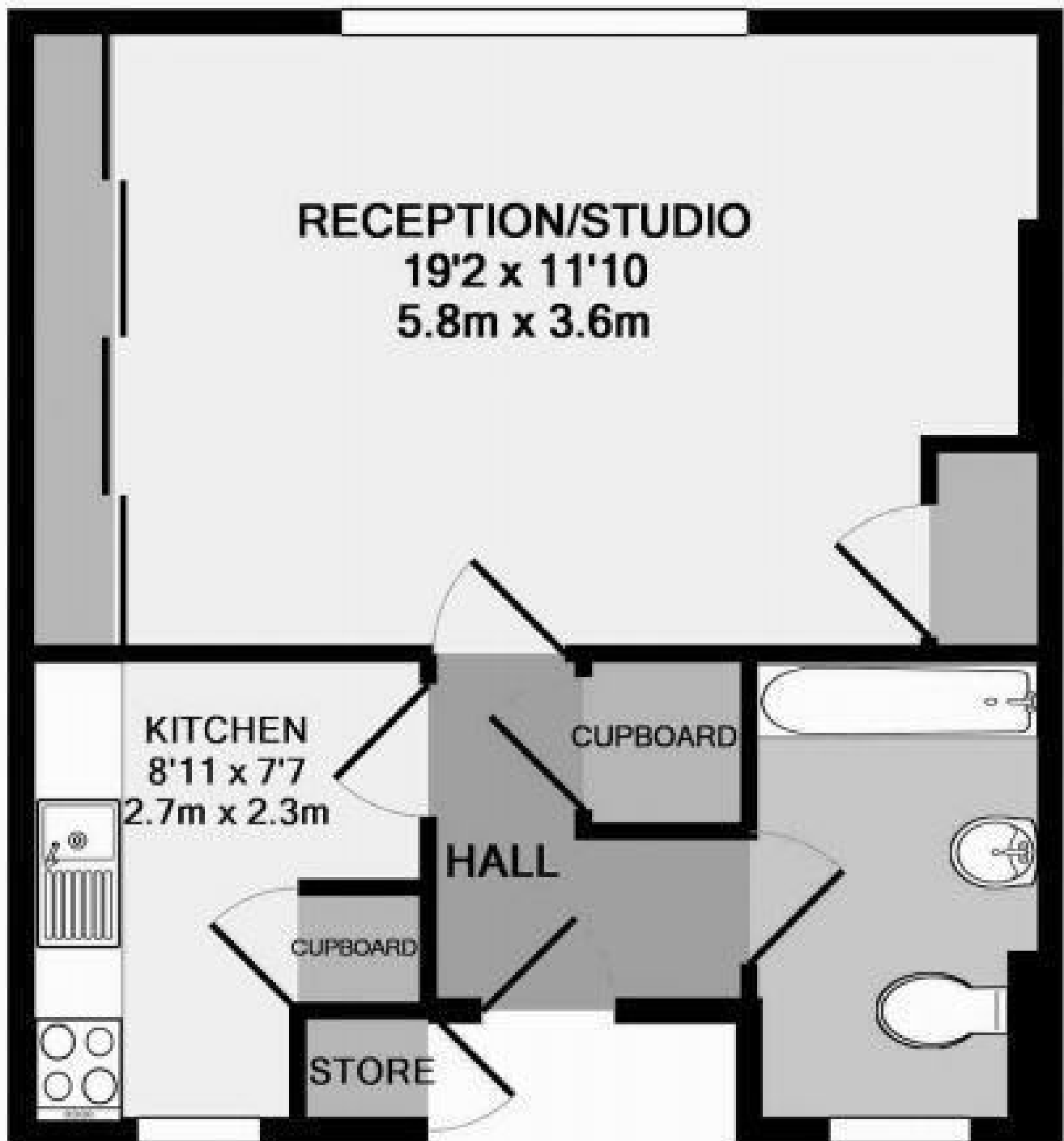

TOTAL APPROX. FLOOR AREA 398 SQ.FT. (37.0 SQ.M.)

IMPORTANT NOTICE All of the information is intended only as a guide to a prospective purchaser and does not constitute any part of an offer or contract. Any measurements or distances referred to herein are approximate only. Any information contained herein (whether in the text, plans or photographs) is given in good faith and cannot be relied upon as being a statement or representation of fact. Should you proceed with the purchase of the property, your solicitor must verify these details. We have not carried out a detailed survey nor tested the services, appliances and specific fittings. In accordance with current legislation we would advise you that the measurements on these particulars are imperial. The formula for conversion to metric is as follows:- 1' (one foot) = 30.4cm (centimetres), 1m (one metre) = 3'29 (feet).